

Intermediate plate, colour grey, suitable for TLD.2/GR

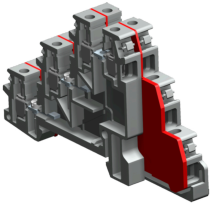
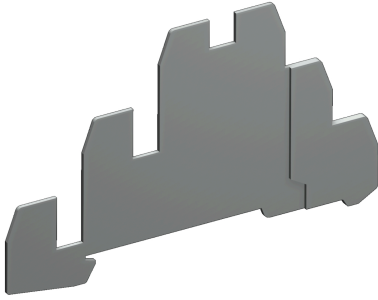

La connessione tra i livelli intermedio ed inferiore del TLD.2 e quelli del TLS.2 contiguo viene realizzata usando le due viti predisposte nei corpi conduttori a forcella del primo TLS.2 della serie.
Per garantire l'isolamento elettrico delle parti conduttrici del morsetto TLD.2, che risulterebbero altrimenti scoperte, si dovrà utilizzare una piastrina intermedia TLD/PI.

The connection between the intermediate and lower levels of TLD.2 and adjacent TLS.2 can be performed by means of the two screws provided in the fork type conducting bodies of the first TLS.2 of the series.
To ensure the electric insulation of the uncovered TLD.2 conducting parts, a TLD/PI intermediate end section must be used.

Series	PT
Code	TL202GR
Type	TLD/PI/GR
HS code	85389099
TECHNICAL DATA	
Typology	Piastrina intermedia
Sub-typology	for series TLD.2
Colour	Grey
Package qty.	25
Material	Polyamide UL94-V0
Width (pitch)	0.8 – 1.5 mm
Length	-
Height	-
Correlations	TLD.2/GR

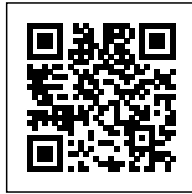

DESCRIZIONE DEL PRODOTTO

Intermediate plate, colour grey, suitable for TLD.2/GR